

Before start, please Read this first

1 General Description

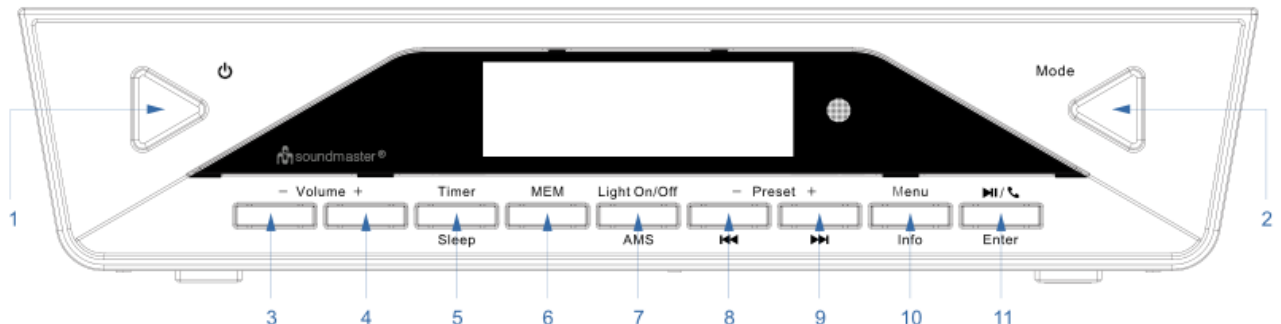



- DAB&FM Digital Tuning System (20DAB+20FM Preset Stations by manual)
- AMS function (Automatic Memory System)
- RDS feature provide radio station name display & automatic time up-date
- Precise crystal is used for system operation
- Real time clock display with day-flag
- 12|24 Hour clock display
- Built in calendar with auto leap year handling within 2000-2099
- 4 mode dual alarms can be set to daily, weekday, week-end and single day independently
- Alarm output can be set to DAB, FM or Buzzer sound
- Automatic or Manual search and Up, Down features are provided
- Electronic Volume Control (32 level)
- Sleep function up to 90 minutes.
- 10 SDA(Special Date Alarm)
- Automatic change to standby mode after 15 minutes if not any sources playing.
- LED Lighting function
- Bluetooth function
- Radio Frequency range:
 - FM: 87.5 ~ 108.0 MHz , 50kHz | Step
 - DAB Band III 174.928-239.2 MHz

Key List



1. :Turn on or turn off the unit
2. Mode: BT, FM, DAB mode selector
3. Volume -:Decrease the volume
4. Volume+:Increase the volume
5. Timer|Sleep: Cooking timer setting and review|Sleep function
6. MEM:Station Memory entry/Preset station review
7. Light On/Off|AMS: Turn ON/Off the Light|Auto Memory Stored for radio station
8. Preset-| :Call back preset station for down| Tune down radio station ,tune the number to last one
9. Preset+| : Call back preset station for up | Tune up radio station , tune the number to next one
10. Menu|Info: Entry to all the basic setting, such as time, date ,alarm and so on | Press to show information of station
11. |Enter: Pause, Free of hand|Function setup, Exit setting, enter and Confirm

Remote Control key list

Key Mark	Function
	Device power On /Off
VOL+	Volume increase
VOL-	Volume decrease
Mode	DAB、FM、 BT selector
	Tune down radio station ,tune the number to last one
 Enter	Pause, Free of hand Function setup, Exit setting, enter and Confirm
	Tune up radio station ,tune the number to next one
Menu Info	Entry to all the basic setting, such as time, date ,alarm and so on Press to show information of station
AMS	Auto Memory System for radio station
Pre-	Call back preset station for down
MEM	Station Memory entry/Preset station review
Pre+	Call back preset station for up
AL1	Review Alarm1
AL2	Review Alarm2
Sleep	Automatic OFF Timer
Timer	Operate for timer function
Dimmer	Adjust the brightness of the display to be high or low
Light On/Off	Turn ON/Off the Light



Assembly Drawing

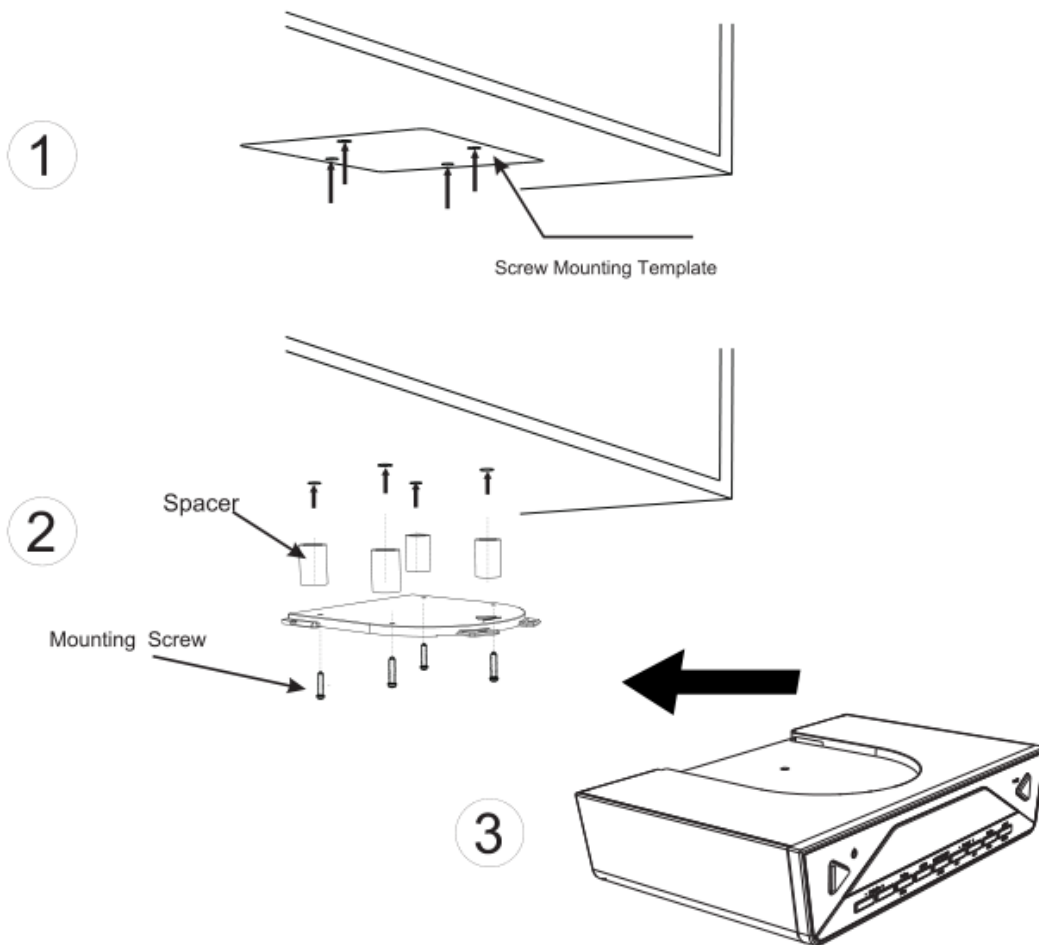

Install the unit as below 3 steps:

1. Place the mounting/drill template under the cabinet with tape, so the unit will be located where you want to, and drill four holes with diameter 1/16 inch drill bit
2. Fasten the screw as the above drawing with supplied Spacer+ mounting bracket+ long screw or mounting bracket + short screw
3. Push the unit to the mounting bracket

Warning: To prevent damage, do not place any heating or cooking appliance beneath the unit, install the unit as far as possible from a source of noise such as fridge, microwave oven etc.

2 Getting start

Power Up

- When device connect to power and it's powered up first time, Automatic update function will start automatically and scrolling text "UPDATE " is display on LCD, it may need few minutes depends signal strength and device working environment , when signal was received, the right time should be display on LCD accordingly. To terminate it, press any key during the period
- When the automatic system setting had been terminate by user or update un-succeed, the date and clock are defaulted to 01.01.2015 , 0:00
- The all alarms are defaulted to 0:00
- The unit is switched to clock auto-run mode
- Default back light automatically set to dim from 23:00 to 05:59 unless you switch the auto dimmer to OFF

Setup Device

When Auto-Run Mode, Press <Menu> once will entry to setting mode.

Use <◀◀> or <▶▶> go to different mode sequentially as below

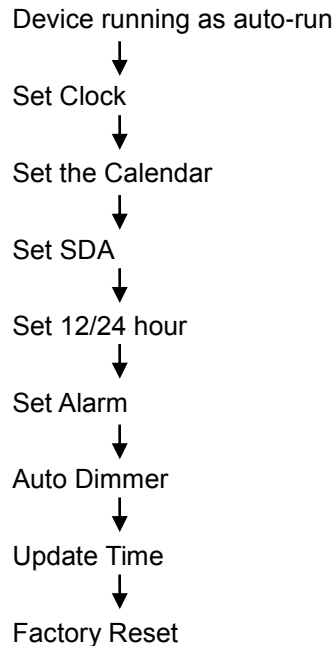

Set the clock

- Press <◀◀> or <▶▶> to set Clock when set menu mode
- Press <Enter> to enter Set Clock.
- Press <◀◀> or <▶▶> to set value of hour.
- Press <Enter> to Confirm hour.
- Same as the hour to set the minute.

Set Calendar

- Press <◀◀> or <▶▶> to set Calendar when set menu mode.
- Press <Enter> to setup value of calendar.
- Press <◀◀> or <▶▶> to set value of dates.
- Press <Enter> to Confirm date value
- Same as the date to set the month and year.

Set the SDA (Special Date Alarm)

When you plan to do something such as you plan to visit somebody but maybe you can't remember, then you can set the SDA to remind you on that day.

- Press <◀◀> or <▶▶> to set SDA when device stay on setting menu mode.
- Press <Enter> to enter set SDA .
- There are total 10 SDA for select .
- Press <◀◀> or <▶▶> to select number of SDA.
- Press <Enter> to confirm selected SDA and enter to set up it
- Press <◀◀> or <▶▶> to set value of date.
- Press <Enter> to Confirm date
- Same as the date to set the month and year.
- when the SDA active, the Beep will sound every hour for 10 minutes from 8:00 to 23:00 if not any key pressed.
- If want to cancel or turn off the SDA, please set the SDA is any of the past days,such as yesterday.

Select Clock format 12 or 24H

- Press < ⏪ > or < ⏩ > to select 12/24 hour format when set menu mode.
- Press <Enter> to enter set 12/24 hour format
- Press < ⏪ > or < ⏩ > to select 12 or24 hour format.
- Press <Enter> to Confirm select and return to set menu.

Set the alarm

- Press < ⏪ > or < ⏩ > to Set Alarm when stay on the setting menu
- Press <Enter> to enter to be start setup alarm :
- Press < ⏪ > or < ⏩ > to select number of alarm.
- Press <Enter> to confirm selected number and enter to hour of alarm selection
- Press < ⏪ > or < ⏩ > to setup value of hour
- Press <Enter> to confirm selected hour value
- Same as the hour to set minute and enter to select output of alarm active:
- there are four kinds of choices, it is respectively as table 1

Kinds	Means	Alarm duration time
OFF	Alarm is disable (default)	0
DAB	DAB sound for alarm active	10 minutes
FM	FM sound for alarm active	10 minutes
Buzzer	Buzzer sound for alarm active	10 minutes

Table (1)

- Press < ⏪ > or < ⏩ > to select the kind of output
- Press <Enter> to Confirm it and enter to days selection,
- There are ten kinds of choices, it is respectively as table 2

Kinds	Means
Daily	Alarm work in every day
Weekday	Alarm work in weekday
Weekend	Alarm work in weekend
Sun, Mon ... Sat	Alarm work in one day of week

Table 2

- Press < ⏪ > or < ⏩ > to select the kind alarm active arrangement
- Press <Enter> to Confirm the select and return to set menu.

Select Auto Dimmer

- Press < **⏪** > or < **⏩** > to select ' Auto Dim ' when stay on setup menu stage.
- Press < **Enter** > to enter set auto dimmer
- Press < **⏪** > or < **⏩** > to select ON or OFF. Default is On
- Press < **Enter** > to confirm selection and return to set up menu.
- When you choose On,, the default back light automatically set to dim from 23:00 to 05:59
- When you choose Off, the device won't dim the back light automatically.

Select Update time

If you need the device update the time everyday, please set it to be ON, if you don't like it update the time, please set it to be OFF

- Press < **⏪** > or < **⏩** > to select ' Update time ' when stay on setup menu stage.
- Press < **Enter** > to enter set update time.
- Press < **⏪** > or < **⏩** > to select ON or OFF. Default is OFF.
- Press < **Enter** > to Confirm selection and return to set up menu.
- If select ON, the device will update the time at 2:00 AM everyday.
- If select OFF, the device will not update the time.

Set factory reset (Be careful to use this action)

- press < **⏪** > or < **⏩** > to select "Reset"
- Make sure you want delete all setup and reset the device to factory default, Press < **Enter** > to confirm it.

3 Using Device

Once Automatic done or finish all setup, Device ready for use now.

3.1 Listen the radio DAB

- Press < **⏻** > once to turn on the radio.
- Press < **Mode** > to select device work mode to DAB



- How to listen DAB station
 - a. When device first to using DAB , Automatic Scan function will start automatically
 - b. Till the action finish ,Select DAB station
 - c. Press < **⏪** > or < **⏩** >once to select DAB station list.
 - d. Press < **Enter** > once to confirm and tune to the station.
- How to Store station into preset station
 - a. Press < **MEM** > once to select location of preset mode.
 - b. Press < **⏪** > or < **⏩** > to change location.
 - c. Press and hold < **Enter** > to store value of station into current location.
- Recall the preset station
 - a. Press < **MEM** > once to select location of preset mode, display show on below information

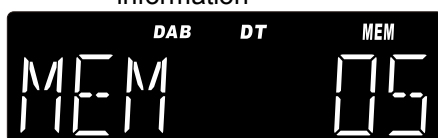

- b. Press < **⏪** > or < **⏩** > to change location.
- c. Press < **Enter** > to confirm select and recall the station.

- How to use AMS
 - a. Press and hold **<AMS>** for 2 seconds to active AMS mode.
 - b. At the moment, the device will automatically scan the DAB station and store the station that had been scanned until scan up all the frequency or stored all the memory station, it will exit automatically.
- Review AMS stored station
 - a. Press **<◀◀>** or **<▶▶>** to select station.
 - b. Press **<Enter>** to confirm select and recall the frequency.
- When play DAB station, Press and hold **<Info>**,
 - a. SCAN>>>Local scan\Auto \Manual for choosing.
 - b. Menu>>>Reset\Version\ Prune for choosing. (Version means review the software version)
- Review the information of station
 - a) Press **<Info>** to review information of station.
 - b) There are Seven kinds of choices, it is respectively:
 1. Station frequency and block number
 2. Data rate
 3. Station RSSI (Station Received Signal Strength Indicator)
 4. Signal error Rate
 5. DLS (Scrolling text)
 6. Program type
 7. Station name

3.2 Listen the Radio FM

Press **<⏻>** key to turn device on, press **<Mode>** select work mode to FM, Display should be show as below:



- How to search station
 1. When the radio is ON, press **<▶▶>** once to change the receiving frequency up by 1 step
 2. Press **<◀◀>** once to change the receiving frequency down by 1 step.
 3. Press and hold **<▶▶>** to search the next radio station automatically by moving the receiving frequency up.
 4. Press and hold **<◀◀>** to search the next radio station automatically by moving the receiving frequency down.
- How to store station into preset location
 1. Press **<MEM>** once to select location of preset mode.
 2. Press **<◀◀>** or **<▶▶>** to change location.
 3. Press and hold **<Enter>** to store value of station into The current location.
- Recall the presented station
 1. Press **<MEM>** once to select location of preset.
 2. Press **<◀◀>** or **<▶▶>** to change location.
 3. Press **<Enter>** to Confirm select and recall the frequency.
- How to set up station by AMS (Automatic Memory Setup)
 1. Press and hold **<AMS>** for 2 seconds to active AMS mode.
 2. In this mode, the radio will automatically scan the radio station and store the station that had been scanned until scan up all the frequency or stored all the memory station, it will exit automatically.

- How to Review stored station:
 1. Press and hold <MEM> to enter select list of AMS store mode.
 2. Press <◀◀> or <▶▶> to select station.
 3. Press <Enter> to confirm select and tune to new frequency
- When play FM station, Press and hold <Info>,
 1. Audio>>>Audio\Mono for choosing.
 2. Menu>>>Reset\Version for choosing. (Version means review the software version)
- Review information of station
 1. Press <Info> to review information of station.
 2. There are three kinds of choices, it is respectively:
 - ✓ Station text
 - ✓ Station Program type
 - ✓ Station RSSI(Station Received Signal Strength Indicator)

3.3 Use Bluetooth function

- Press <⏻>key to turn device on, press <Mode> select work mode to BT as the below,



- the icon of BT flashing, press <Enter> for 2 seconds, open the Bluetooth function of the source device (such as cellphone), chose connecting, once connected, the icon of BT will be solid. Then you can begin to play music or answer the telephone.
- When you want to play music, you can use <⏸> to pause, use the <◀◀> and <▶▶> to choose the last track or next track.
- When you want to answer the telephone, when listen the telephone ring ,press <Enter> to answer the phone, if the device is not on BT mode, you need to press <Mode> to BT mode first.
- When you want to dial someone, dial the telephone number with your cellphone, then speak in the front of the device.

Note: The device will search the last connected cellphone automatically.

3.4 Using Cooking Timer

- Press <Timer> once to entry the timer mode,
- Press <◀◀> or <▶▶> to choose the five value (00:10 or 00:15 or 00:30 or 00:40 or 1:00) , press <Timer> to start counting.
- if you want to set any time you need, press<Timer>once, then press <Info> to set minute by <◀◀> and <▶▶> ,then press <Enter> to set hour by <◀◀> and <▶▶> ,then press <Enter> to confirm the set, press <Timer> to start counting.
- When the timer is running press <Timer> could be pause it or press <Timer> again to continue.
- Press and hold <Timer> for 2 seconds to terminate the timer and leave, when the timer is running.
- Beep sound alarm is selected,
 - a. Sound of beep toggles at the Speaker
 - b. The duration of alarm is 10 minutes
- Press any key to terminate the currently active alarm.

3.5 Using the LED lamp

Press "Light on/off" once, the lamp will on, press again will off, when lamp on and not off by user, it's will automatic off for 120 minutes.

3.6 Using Sleep function

The function let user setup a timer to let device automatic power off

- Press <Sleep> for 2 seconds to active sleep function, if device stay on the standby, will turn on the device.
- Press the key every time will change each 5 minutes, value of timer since 90 to OFF.
- Press other key to start its corresponding function with the sleep timer is run at background
- When no key has been pressed for 15 seconds, the system exit sleep timer display mode, but the sleep timer is run at background, and the icon of bed showed on the display.
- Once <Sleep> was pressed for 2 seconds, The current sleep value will be shown on display.
- If want to cancel the sleep, press <Sleep> several times until it to OFF.

3.7 Electronic Volume Control

- Press <Volume+ > once, to increase speaker volume by one step. Hold for continually.
- Press <Volume-> once, to decrease speaker volume by one step. Hold for continually.
- Adjust Volume control sound output to a comfortable level , don't make it too loud.

Technical Data

Input voltage, current:	DC5.5V,2A
Power consumption:	12W
Radio Frequency range:	FM: 87.5 ~ 108.0 MHz , 50kHz Step DAB Band III 174.928-239.2 MHz
Store temperature:	-10°to +65°
Operating temperature:	0°to +35°

Specifications are subject to change without further notice.
Copyright by Wörlein GmbH, D 90556 Cadolzburg.



PROTECTION DE L'ENVIRONNEMENT



Ne jetez pas ce produit avec les ordures ménagères lorsqu'il est usagé. Retournez-le à un point de collecte pour le recyclage des appareils électriques et électroniques. Cette recommandation est indiquée par le symbole sur le produit, le mode d'emploi ou l'emballage.

Les composants sont réutilisables en fonction de leur marquage. En réutilisant, recyclant ou employant autrement les vieux appareils, vous contribuerez de façon significative à la protection de notre environnement.

Veuillez contacter vos collectivités locales pour vous renseigner sur les points de collecte.

	ATTENTION Risque d'électrocution Ne pas ouvrir!	
Attention! Pour réduire le risque d'électrocution, ne retirez pas le couvercle (ou l'arrière). L'utilisateur ne peut entretenir aucune pièce à l'intérieur. Confiez l'entretien à un personnel qualifié.		



Ce symbole indique la présence d'une tension dangereuse à l'intérieur de l'appareil, qui est suffisante pour provoquer un choc électrique.



Ce symbole indique la présence de consignes importantes de fonctionnement et d'entretien de pour l'appareil.

Consignes de sécurité, d'environnement et d'installation

- N'utilisez l'appareil qu'à l'intérieur dans un lieu sec
- Protégez l'appareil contre l'humidité
- N'ouvrez pas l'appareil **RISQUE D'ELECTROCUTION !** Faites effectuer l'ouverture et l'entretien par un personnel qualifié
- Ne connectez cet appareil qu'à une prise murale correctement installée et reliée à la terre Assurez-vous que la tension principale corresponde aux recommandations de la plaque d'indice
- Assurez-vous que le câble d'alimentation reste au sec pendant le fonctionnement. Ne pincez pas le câble et ne l'endommagez d'aucune façon
- Un câble de réseau ou une prise abimés doivent être immédiatement remplacés par un centre agréé.
- En cas de tonnerre, débranchez immédiatement l'appareil de l'alimentation.
- Les enfants doivent être surveillés par leurs parents lorsqu'ils utilisent l'appareil.
- Ne nettoyez l'appareil qu'avec un tissu sec.
N'utilisez PAS de PRODUITS DETERGENTS ou de CHIFFONS ABRASIFS !
- N'exposez pas l'appareil à la lumière directe du soleil ou toute autre source de chaleur
- Installez l'appareil dans un emplacement suffisamment ventilé pour éviter une accumulation de chaleur.
- Ne recouvrez pas les grilles d'aération !
- Installez l'appareil dans un emplacement sécurisé et sans vibrations.
- Ne pas installer l'appareil à proximité d'ordinateurs et fours à micro-ondes; sinon la réception de radio pourrait être perturbée.
- Ne pas ouvrir ou réparer l'appareil. Cela est dangereux et annulerait la garantie. La réparation doit être uniquement effectuée que par un centre de réparations / service agréé.
- N'utilisez que des piles au mercure et sans cadmium.
- Les piles usagées sont des déchets dangereux et ne doivent PAS être jetées avec les ordures ménagères !!! Ramenez les piles à votre point de vente ou aux points de collecte de votre ville.
- Eloignez les piles des enfants. Les enfants pourraient avaler les piles. En cas d'ingestion d'une pile, contactez immédiatement un médecin.
- Vérifiez régulièrement vos piles pour éviter les fuites.
- Las baterías no deberán estar expuestas a un calor excesivo como el sol, el fuego o similares.
- PRECAUCIÓN: Peligro de explosión si la batería se sustituye incorrectamente
Reemplace sólo con el mismo tipo o equivalente



Les piles usages sont des déchets dangereux et ne doivent PAS être jetées avec les ordures ménagères ! La loi impose aux consommateurs de disposer de toutes les piles pour un recyclage écologique – et ce que les piles soient de contenance dangereuse ou pas*).

U kunt batterijen gratis terugbrengen naar openbare inzamelingspunten in uw gemeente of bij winkels die de betreffende soort batterijen verkopen.

Alleen volledig lege batterijen.

*) met de markering Cd = cadmium, Hg = kwik, Pb = lood